

# Pièce de reprise en main du logiciel CAO-3D

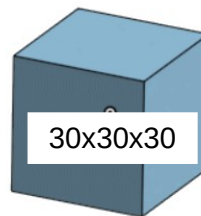

**Esquisse 1 :** Rectangle  
par son centre  
(sur origine)

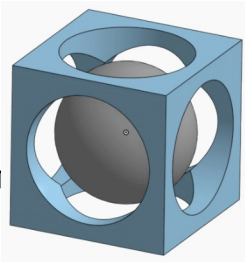
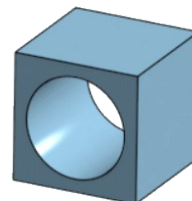
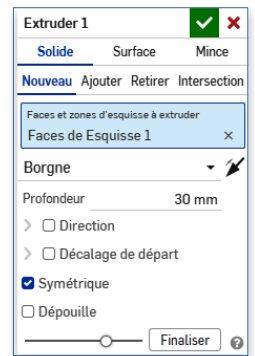
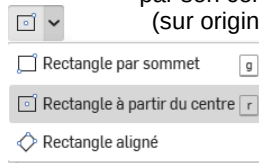

**Esquisse 2 :** Cercle  
par son centre  
(sur origine)

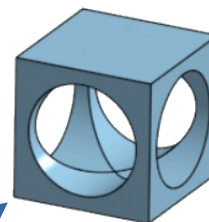
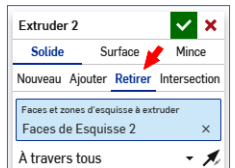
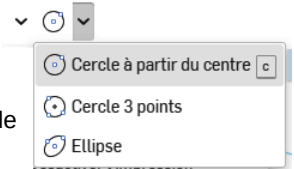

**Ø 24  
à travers  
tout**

**Ø 24  
à travers  
tout**

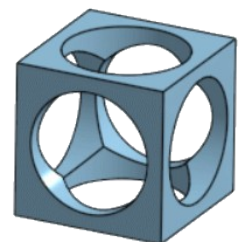

**Esquisse 5**

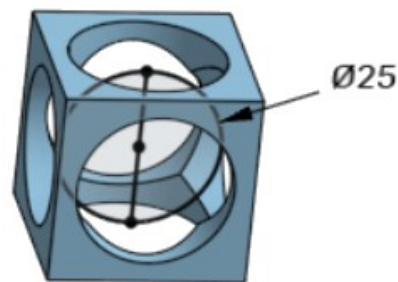

**Pivoter**

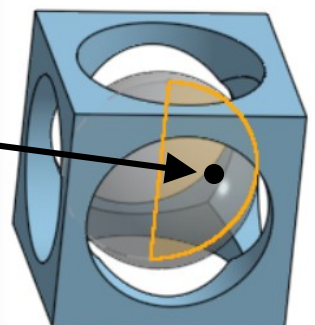
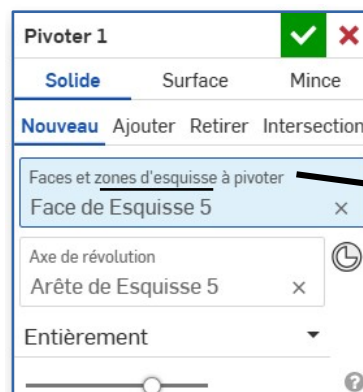

Filtrer par nom ou type

Fonctions (14)

✓ Géométrie par défaut

Origin

Top

Front

Right

Esquisse 1

Extruder 1

Esquisse 2

Extruder 2

Esquisse 3

Extruder 3

Esquisse 4

Extruder 4

Esquisse 5

Pivoter 1

✓ Pièces (2)

Part 1

Part 2

1.1

1.2

1.3

1.4

2

## A RETENIR :

-Dans Onshape, il faut...

1- d'abord choisir un plan

2- puis faire une esquisse

3- et finir par une extrusion.